

rigid cast aluminum, heavy duty commercial  
**9-inch architectural bollards**

www.valuelight.com

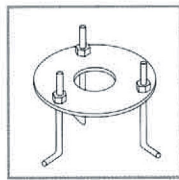
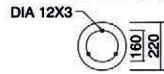
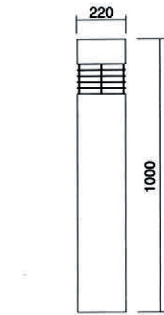

Mounting plate with anchore bolts for installations is available seperately

IP 55 Class I

- Corrosion resistant die cast aluminium and aluminium alloy body components
- Extruded aluminium pole
- Stainless steel screws
- Vandal proof UV stabilized dome prismatic polycarbonate diffuser
- Integral control gear
- UV Stabilized polyester powder coating
- Available color : Black / Silver / White

**Applicable lamp**

Standard incandescent			
1XA60	E27	100W	1380lm
Compact fluorescent			
1XTC-D	G24 d-3	26W	1800lm
Electronic compact fluorescent			
1XTC-DSE	E27	20W	1200lm
Mercury vapour			
1XHME	E27	80W	4000lm
High pressure sodium			
1XHSE-E	E27	70W	5600lm
Metal halide			
1XHIE/M	E27	70W	4900lm

**CAT. OD-7118**



**CAT. OD-7110**



valuelight.com

practical ideas  
 you need to  
 design specify  
 superior  
 lighting systems